

MATISSE'S WORKSHOP

PERFECT FOR THE ARTIST IN YOU

QUALIFIED INQUIRIES ONLY



LOCATION

**11-16 37th AVENUE
LONG ISLAND CITY, NY**

BLOCK & LOT: 361 / 20
SPACE: 4,700 SF
GROUND FLOOR
ZONING: MI - 3

FEATURES

LIKE NEW TURN-KEY BUILDOUT

18' CEILING HEIGHT
ONE 14' DRIVE-IN DOOR
HVAC AND SECURITY SYSTEM IN PLACE
FULL KITCHEN AND SHOWER

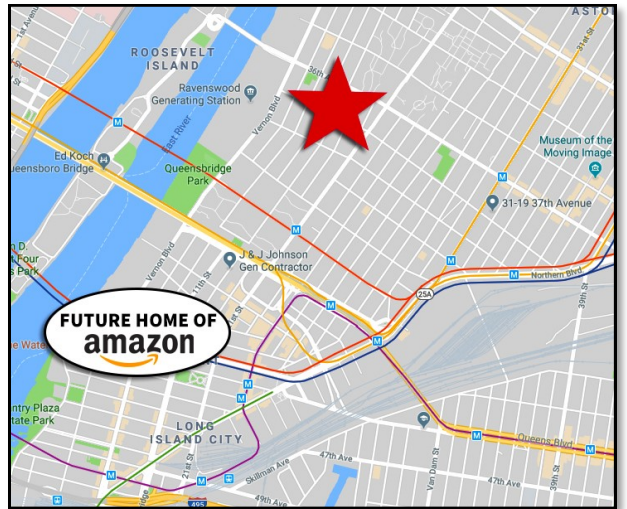
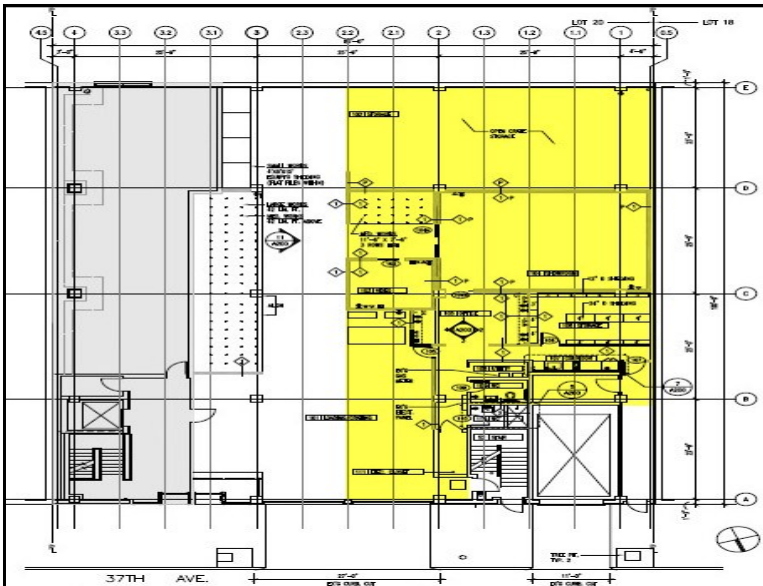

**FOR ADDITIONAL INFORMATION
CONTACT EXCLUSIVE AGENTS:**

718-786-5050

DREW MALTZ

dmaltz@greiner-maltz.com

RYAN MALTZ

ryanmaltz@greiner-maltz.com

Any information set-forth herein has been obtained from sources deemed reliable, however, we have not verified it, and make no representation or warranty of any kind, including without limitation: condition: either latent or patent, size or manner of construction of the property, compliance with local law, and environmental conditions. All information submitted herein is subject to errors and omissions, and the right of our principal(s), to withdraw, modify, or condition the listing without prior notice.

Broker cooperation encouraged.

INDUSTRIAL, COMMERCIAL and RETAIL REAL ESTATE Since 1953

GREINER-MALTZ
REAL ESTATE
www.greiner-maltz.com

